



KANEBRIDGE

**TAP
&
FRAME
BOLTS**

TAP BOLTS

INCH

¼-20 thru 1" diameters
Lengths thru 15 inches

- 18-8 Stainless Steel
- Grade 5
- Grade 8 (Zinc Yellow & Plain)
- Low Carbon

METRIC

M4 thru M24 diameters
Lengths thru 90 mm

- DIN 933, Class 8.8
- DIN 933, Class 10.8

OVER
1000
ITEMS



Full manufacturer's certification furnished free of charge for all items (on request)

Use Tap Bolts when greater thread length than Hex Cap Screws is necessary or when using a stud and nut would be impractical.

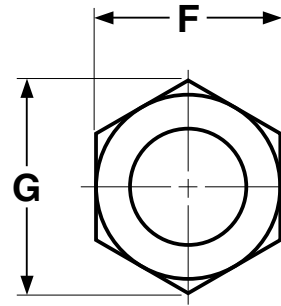
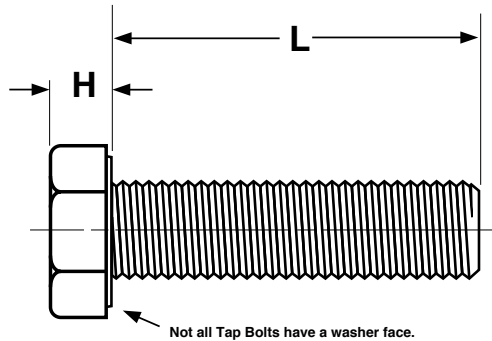

FULLY THREADED HEX TAP BOLTS

IFI-199 (2014)

Nominal or Basic Product Diameter	F			G		H		
	Width Across Flats			Width Across Corners		Head Height		
	Basic	Max.	Min.	Max.	Min.	Basic	Max.	Min.
1/4	7/16	0.438	0.428	0.505	0.488	5/32	0.163	0.150
5/16	1/2	0.500	0.489	0.577	0.557	13/64	0.211	0.195
3/8	9/16	0.562	0.551	0.650	0.628	15/64	0.243	0.226
7/16	5/8	0.625	0.612	0.722	0.698	9/32	0.291	0.272
1/2	3/4	0.750	0.736	0.866	0.840	5/16	0.323	0.302
9/16	13/16	0.812	0.798	0.938	0.910	23/64	0.371	0.348
5/8	15/16	0.938	0.922	1.083	1.051	25/64	0.403	0.378
3/4	1 1/8	1.125	1.100	1.299	1.254	15/32	0.483	0.455
7/8	1 5/16	1.312	1.269	1.516	1.447	37/64	0.604	0.531
1	1 1/2	1.500	1.450	1.732	1.653	43/64	0.700	0.591
1 1/4	1 7/8	1.875	1.812	2.165	2.066	27/32	0.876	0.749

Tolerance on Length	Nominal Screw Size	Nominal Size				
		Up to 1 in., incl.	Over 1 in. to 2-1/2 in., incl.	Over 2-1/2 in. to 4 in., incl.	Over 4 in. to 6 in., incl.	Over 6 in.
	1/4 to 3/8	-0.03	-0.04	-0.06	-0.10	-0.18
	7/16 and 1/2	-0.03	-0.06	-0.08	-0.10	-0.18
	9/16 to 3/4	-0.03	-0.08	-0.10	-0.10	-0.18
	7/8 and 1	...	-0.10	-0.14	-0.16	-0.20
	1 1/4	...	-0.12	-0.16	-0.18	-0.22

FRAME BOLTS

INCH

5/16" thru 5/8" diameters

- 18-8 Stainless Steel

Lengths from 1/4" thru 3/4"

- Grade 8

METRIC

M6 thru M12 diameters

- DIN 6921, Class 8.8
- DIN 6921, Class 10.8

OVER
250
ITEMS



Full manufacturer's certification furnished free of charge for all items (on request)

A one-piece hex-washer head bolt with a flat bearing surface commonly used on truck frames . Also referred as flange bolts, it eliminates the need for a washer and helps compensates for misaligned hole.

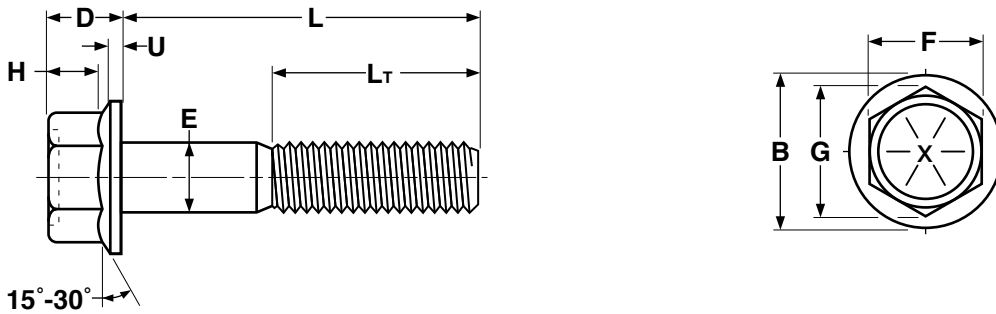

‡Length of a frame bolt is measured from the underhead bearing surface to the extreme end of the screw.

FRAME/FLANGE BOLTS

IFI-111 (2014) &
SAE J429

Nominal Size	E		F			G		B	U	D	H	L _T	Gr-8 Alloy Bolts Only	
	Body Diameter		Width Across Flats			Width Across Corners		Flange Diam.	Flange Thickness	Head Height	Hex Height	Thread Length	Tensile Strength, Lbs.	Proof Load, Lbs.
	Max	Min	Basic	Max	Min	Max	Min	Max	Min	Max	Min	Basic		
1/4	0.2500	0.2450	3/8	0.3750	0.367	0.433	0.409	0.56	0.04	0.28	0.17	0.750	4,750	3,800
5/16	0.3125	0.3065	1/2	0.5000	0.489	0.577	0.548	0.68	0.05	0.32	0.21	0.875	7,850	6,300
3/8	0.3750	0.3690	9/16	0.5625	0.551	0.650	0.618	0.81	0.06	0.425	0.25	1.000	11,600	9,300
7/16	0.4375	0.4305	5/8	0.6250	0.612	0.722	0.685	0.93	0.07	0.46	0.30	1.125	15,900	12,800
1/2	0.5000	0.4930	3/4	0.7500	0.736	0.866	0.825	1.07	0.08	0.555	0.34	1.250	21,300	17,000
5/8	0.6250	0.6170	15/16	0.9375	0.922	1.083	1.034	1.33	0.10	0.690	0.42	1.500	33,900	27,100
3/4	0.7500	0.7410	1-1/8	1.1250	1.100	1.299	1.234	1.59	0.11	0.825	0.51	1.750	50,100	40,100

Tolerance on Length	Nominal Bolt Size	Nominal Bolt Length		
		Up to 1 in., incl.	Over 1 in. to 2-1/2 in., incl.	Over 2-1/2 in. to 4 in., incl.
	1/4 to 3/8	-0.03	-0.04	-0.06
	7/16 and 1/2	-0.03	-0.06	-0.08
5/8 and 3/4	-0.03	-0.08	-0.10	

THE KANEBRIDGE ADVANTAGE



- We are a distributor that only sells to other distributors
 - We stock over 43,000 items
 - We carry inventory at three locations:
Elgin IL, Bell CA, and Oakland NJ
-

- 1 carton minimum to order
 - Save an additional 2% by ordering online
 - Save when ordering 5 or more cartons on any combination of items
-

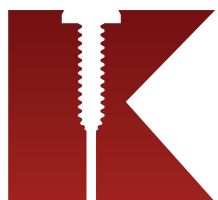

Place orders:

- by phone (888-222-9221)
- by fax (201-337-2301)
- online at www.kanebridge.com

THE FASNET™ ADVANTAGE

Make sure to utilize all the information, benefits, and convenience of our online system.



Search Over 43,000 Items

Search for Products, View Prices and Place Orders Instantly by:

- Part Number
- Keyword
- Category



Expedite

- Track UPS Shipments
- View Invoices, Lot Certifications, Packing Slips & RoHS Certifications
- Submit A Return Authorization Request



Discount Prices

View our list of Steel and Stainless Steel items selling below import pricing.



Open Returns & Credits

View a listing of open returns and/or credits.



Fastener Specification Guide

View the latest technical information on over 800 fasteners.



Additional Information

Plating Info, Hole Size Recommendations, Product Comparisons, Metric Resources, and more.



Cross-Reference Tables

Use Kanebridge's Item Cross-Reference Tables to search for an item by an industry-standard part number.



Branch Listing

View and edit information of your branches.



Account Statement

View open invoices and a summary of your account statement.

3 U.S. Warehouse Locations Coast to Coast

99% Service Level

Same Day Shipment

1 Carton Minimum to Order

T (800) 222-9221

F (201) 337-2301

sales@kanebridge.com

www.kanebridge.com

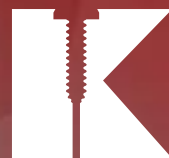

**KANEBRIDGE
CORPORATION**
New Jersey · Illinois · California